

REV.	DATE	DRN.	CKD.	NOTES
A	17/04/19	SA	GT	AMENDED TO PLANNERS COMMENTS

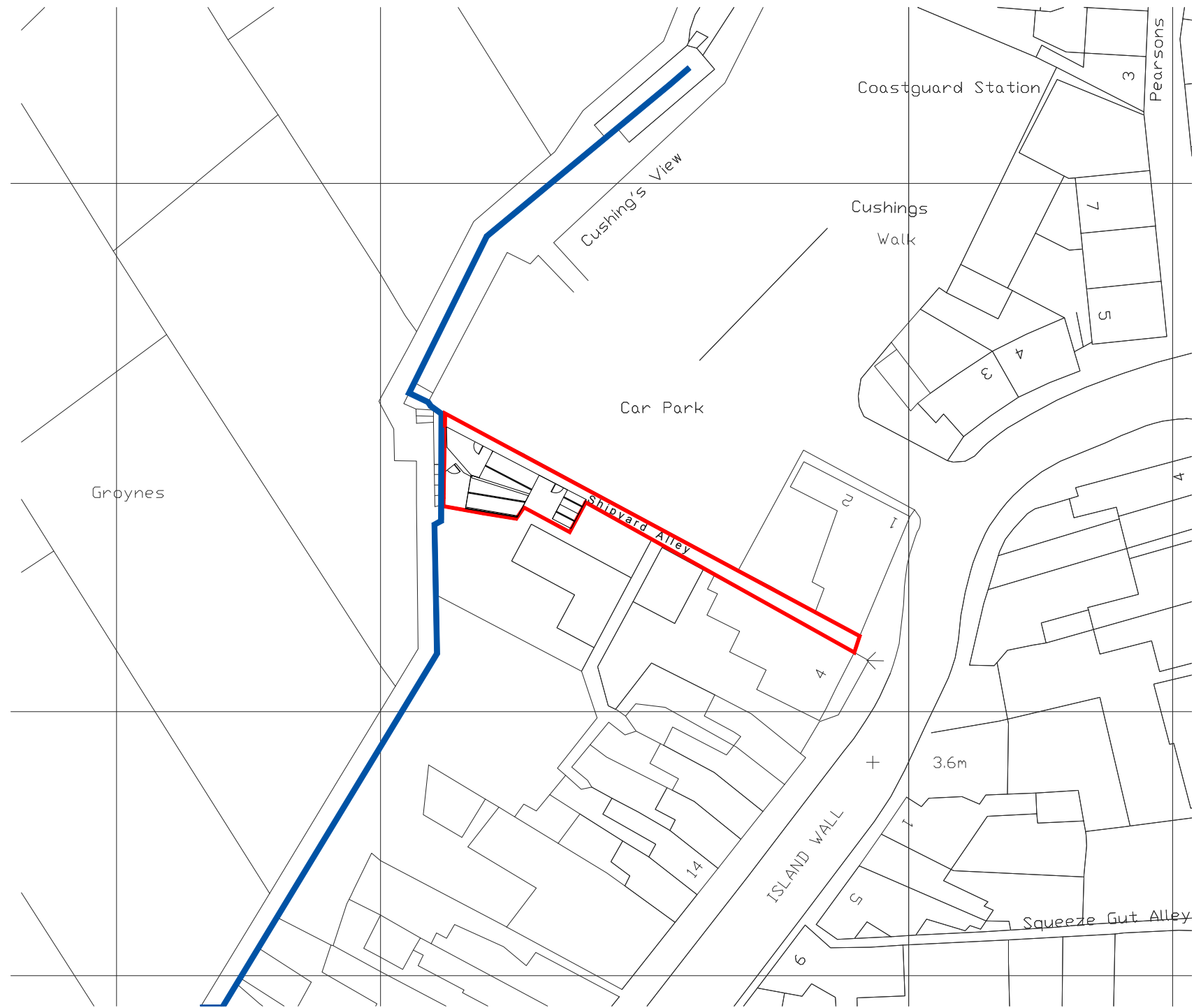

chartered architects
and planning consultants

Lee Evans Partnership LLP,
Canterbury: St Johns Lane, Canterbury, Kent CT1 2QQ Tel: 01227 784444
London: 175-185 Gray's Inn Road, London Tel: 0207 812 0640
email: architect@lee-evans.co.uk website: www.lee-evans.co.uk Fax: 01227 819102

PROJECT
Keams Yard, Whitstable : 3 New Beach Huts

CLIENT
Whitstable Oyster Company and J.G & R Green and Mr J.Knight 31/10/2018

DRAWING TITLE
PROPOSED BLOCK PLAN DRN + CKD SA GT

ISSUE STATUS
PLANNING DRAWING 1:500 @ A3

DRAWING NUMBER
08077-PL-(00)-X-0206 REVISION A