

Copyright, design rights or other intellectual property rights in this drawing remain the property of Blackrock Architecture Ltd. The plans and information contained within are supplied on the express condition that they are not used in connection with the production of any building components nor the design, erection or construction of any building unless with the permission of Blackrock Architecture Ltd. The plans may not be copied, reproduced, adapted or passed to any third party for any other purpose without the express consent of Blackrock Architecture Ltd.

Do not scale working dimensions from this drawing, with all dimensions to be checked and verified on site.

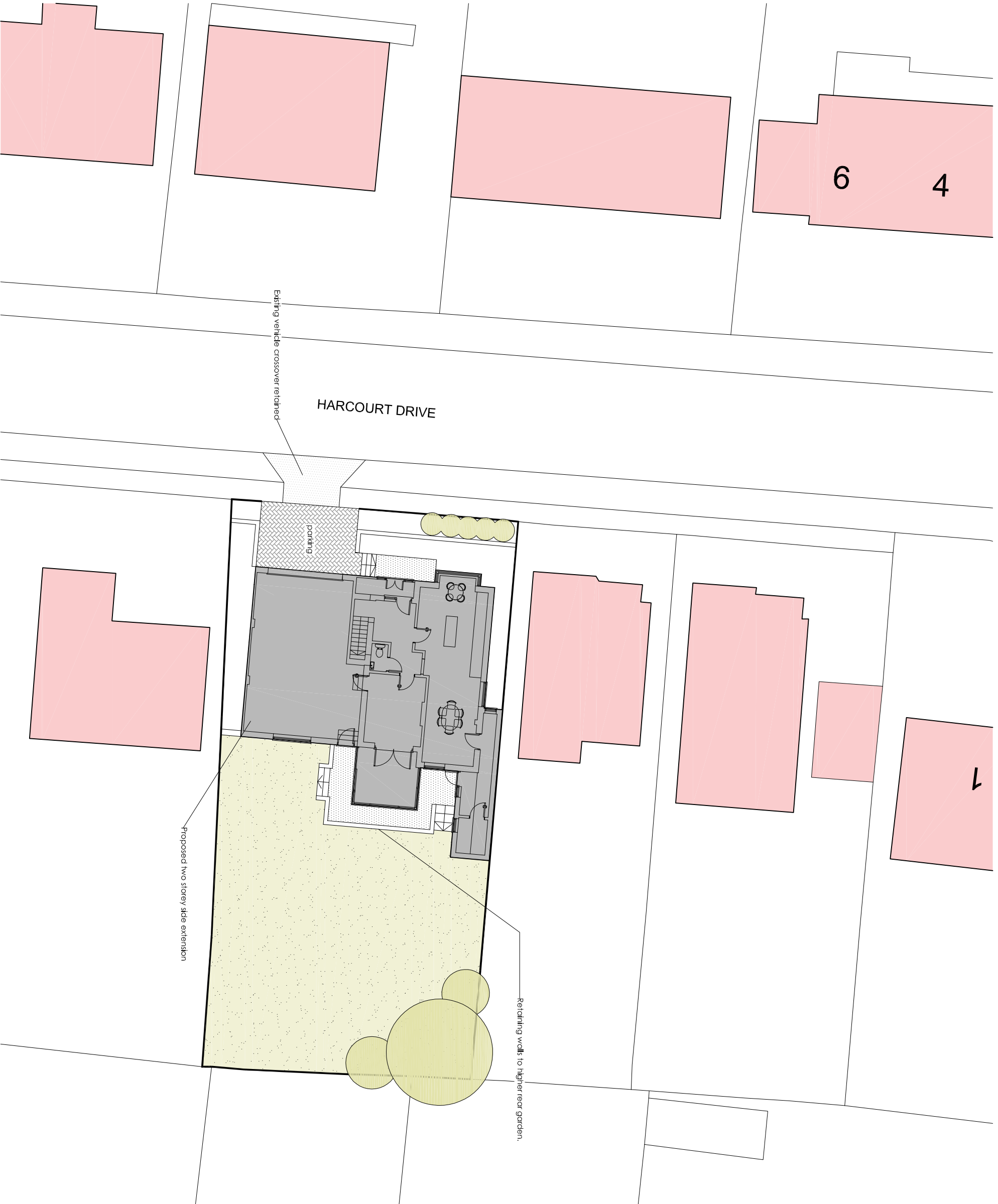
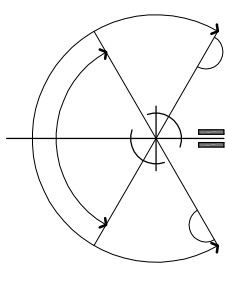

D Jan 19 SH Updated lilline with planners and clients comments
 C Nov 18 SH Updated lilline with planners and clients comments
 B Sept 18 SH Updated lilline with clients comments
 A Aug 18 SH Issued for approval

block plan



Blackrock Architecture Ltd

Architectural & Planning Consultants

Unit 42 Canterbury Innovation Centre Canterbury Kent CT2 7FG
 T: 01227 281743 M: 07771 616348 E: info@blackrock-architecture.co.uk

Project 7 Harcourt Drive, Heme Bay
 Drawing Title Proposed site block plan

Client Mr & Mrs Warren
 Scale 1:200 @ A3
 Drawing No. 1251/05 D