

Existing Site Block Plan
1:500

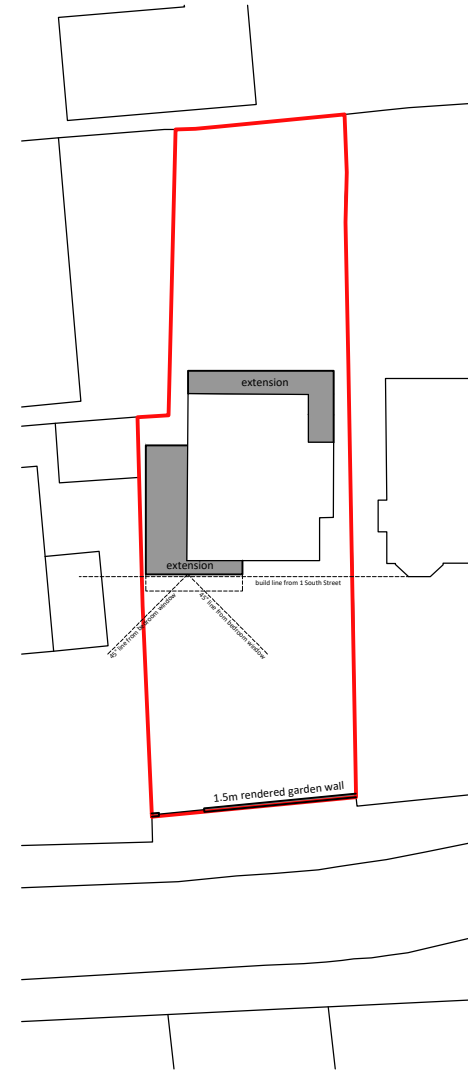

Proposed Site Block Plan
1:500

3 South Street, Whitstable

Extensions and Internal Alterations

Existing and Proposed Site Block Plans

1:500 @ A3

07 A

invent
ARCHITECTURE

T: 01227 282247
W: invent-architecture.co.uk
A: 24 Oxford Street, Whitstable, CT5 1DD

